

Control Panel Features

1. **MIC/INST Input** - Use this XLR/¼" input for microphone, instrument with and active preamp or a line signal.
2. **LEVEL (CHANNEL 1)** - Used to control the level of the CHANNEL 1 Mic/Line input.
3. **AUX IN** - Connect a line level device using a 3.5mm audio cable.
4. **LINE Input** - ¼" input used to connect instrument or line level signals.
5. **LEVEL (CHANNEL 2)** - Used to control the level of the MP3 IN and LINE inputs.
6. **2.4GHz WIRELESS Input*** - Connect the Samson Stage XPD1 digital wireless USB receiver to this input. The wireless receiver gets its power from the XP106, so no additional power supply is needed.
7. **LEVEL (WIRELESS)** - Used to control the level of the 2.4GHz WIRELESS input.
8. **LINE OUT** - ¼" output connector to link multiple XP106 systems together
9. **LEVEL (BLUETOOTH®)** - Used to control the level of the *Bluetooth* input.
10. **SPEECH/MUSIC Switch** - This switch is used to change the overall frequency response, or tone contour, for the XP106 sound system. If your application is mainly for music, leave the switch up to select the MUSIC response curve. If your application is mainly for spoken word, press the switch down to select the SPEECH response curve.
11. **Power** - Switches on the main power.
12. **PEAK LED** - The Red LED illuminates at the level where distortion occurs.
13. **Battery Indicator** - Displays the status of the battery charge level.
14. **DC IN** - Connect the supplied power adapter here.

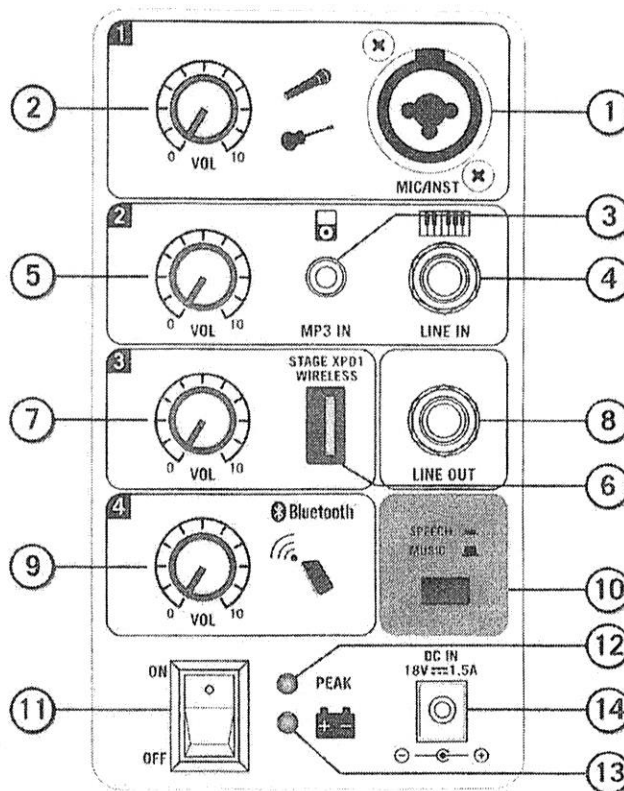

* The USB connector is for the Stage XPD1 receiver only. The connector is not designed to charge smartphones, tablets, or similar devices.

Control Panel Features

- 15. **Pairing Indicator** - Displays the *Bluetooth* status of the XP106 system.
- 16. **Pairing Button** - Press this button to enable pairing mode in order to connect to a *Bluetooth* audio device.

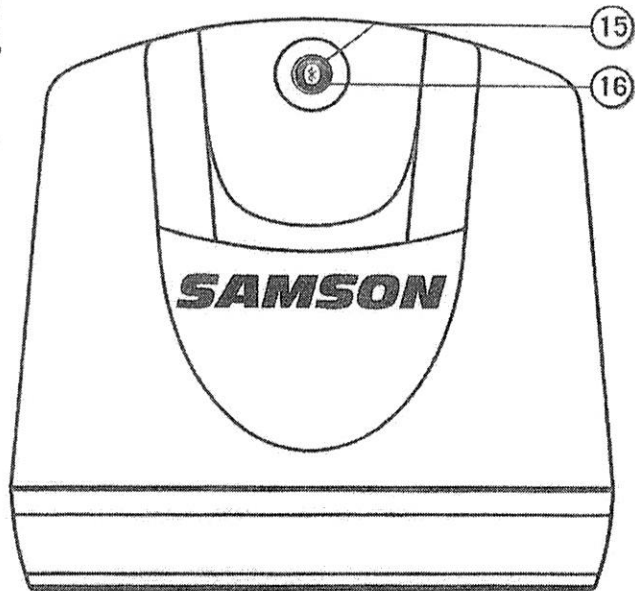

Quick Start

Follow these steps below to quickly get started using your XP106 portable sound system.

- Set the XP106's power switch to the **OFF** position, and fully turn all of the **LEVEL** controls counterclockwise to **0**.
- If an outlet is available, connect the included power adaptor to the **DC IN** of the speaker, and plug it into an AC socket.
- Connect a microphone using a standard XLR cable, line level equipment using a 1/4" instrument cable, or portable audio device using a 1/8" cable.
- Switch on the XP106 power.
- While speaking into the microphone or playing music from a line level audio source, slowly raise the channel **LEVEL** until you have reached the desired level.

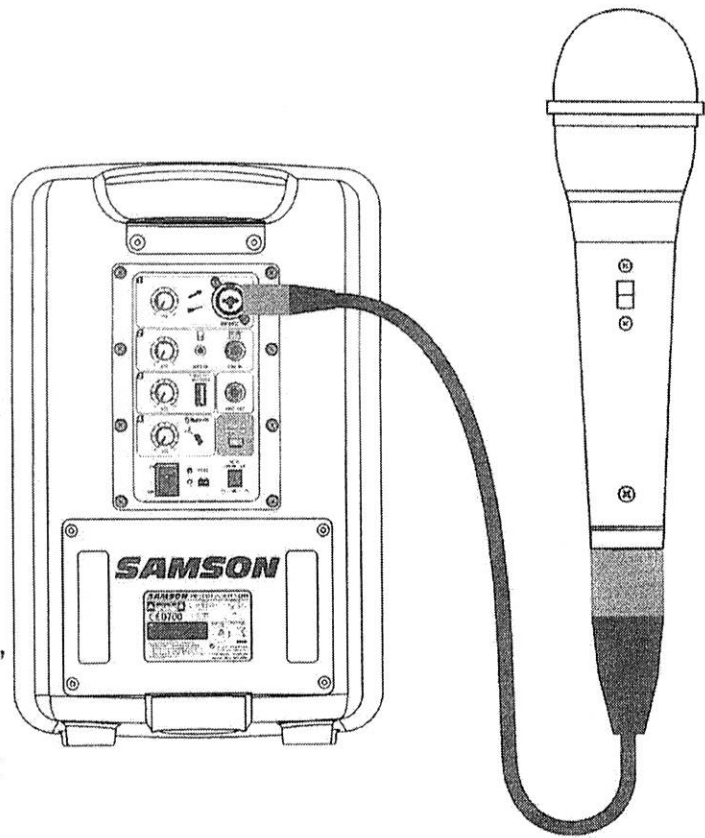

NOTE: If not using the channel 1 input, turn the **LEVEL** control all the way down to keep out any unwanted noise.

Setting a Good Level

Use the Channel **LEVEL** controls to set the individual volume of your microphone, line level and *Bluetooth*[®] devices.

The **PEAK** light illuminates when the signal sending to the internal amplifier begins to reach a level where distortion occurs. If the **PEAK** lights stay on, your mix is too hot and you need to lower the **LEVEL** controls. It is okay for the **PEAK** light to occasionally light, however it should go off quickly and should not constantly stay on.

ENGLISH

FRANCAIS

DEUTSCHE

ESPAÑOL

ITALIANO

Pairing with a Bluetooth® device

Bluetooth® is a wireless communication technology that allows for connectivity between a wide range of devices. The XP106 uses *Bluetooth* to stream high quality audio from your *Bluetooth* enabled device without the need for connecting any cables. In order for your device to work with the XP106 it must first be paired.

1. Turn all channel VOL controls down counterclockwise to **0**.
2. With the XP106 and your *Bluetooth* device powered on; press the PAIR button on the top panel of the XP106 speaker to make the speaker discoverable. The *Bluetooth* indicator will slowly flash blue.
3. In the settings of your *Bluetooth* device, set it to "discover" available devices.
4. From the *Bluetooth* device list, select the "Samson XP106" device.
5. If your device asks for a passkey, enter digits 0000 (four zeros) and press OK. Some devices may also ask you to accept the connection.
6. As the XP106 is connecting to your device, the *Bluetooth* indicator will quickly flash blue.
7. The XP106 speaker indicates that pairing is complete when the indicator turns steady blue. You can now stream audio from your device to the XP106 speakers.
8. With the volume control on your *Bluetooth* device turned up, play some music, and slowly raise the XP106 BLUETOOTH channel **VOL** control until you have reached the desired level.

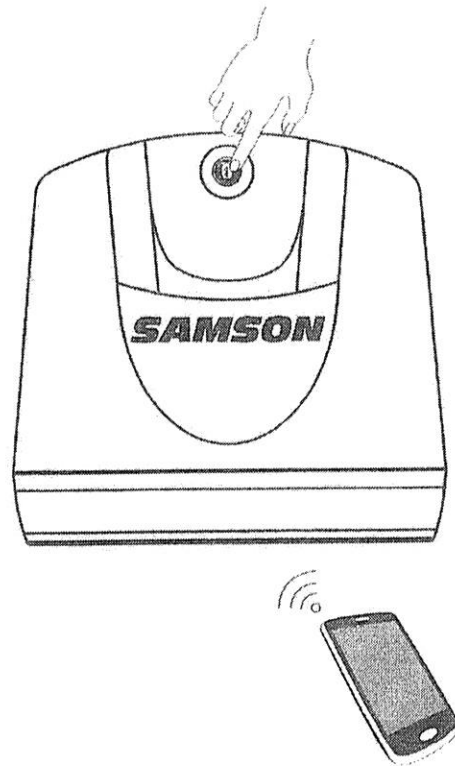

Charging the Battery

The XP106 has an internal, rechargeable battery capable of up to 20 hours of continuous audio on a full charge. Even though the system may have some charge when first taken out of the box, we recommend fully charging your XP106 before first using the system.

To charge the battery:

- Set the power switch to the "OFF" position.
- Connect the XP106 to an AC power outlet using the included power adapter.
- Keep the system plugged in until the Battery indicator changes to green, indicating the battery is fully charged.

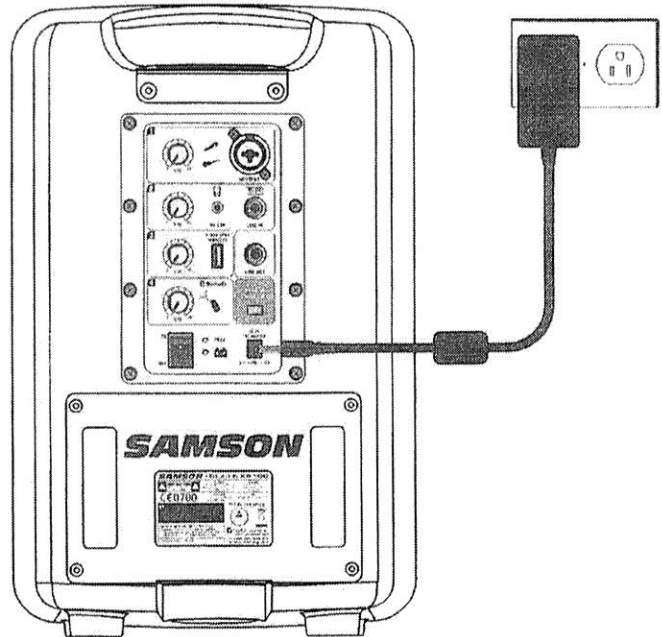

The XP106 utilizes a sealed lead-acid gel cell battery. When not in use, the battery will slowly self-discharge. If you are planning not to use the XP106 for a long period of time, it is advised to fully charge the unit before storing. It is also important to charge the unit every six months when not used. This will ensure a healthy battery and extend its life. If the battery is left with a very low charge for an extended period of time, it is possible to recharge the battery to working condition, but the charge time can take over 24 hours.

If you find that the operation time of the XP106 becomes noticeably decreased, even after fully charging, the battery should be replaced. Contact Samson customer service or your local distributor for a replacement battery.

ENGLISH

FRANÇAIS

DEUTSCHE

ESPAÑOL

ITALIANO

Quick Start - Stage XPD1 Wireless System

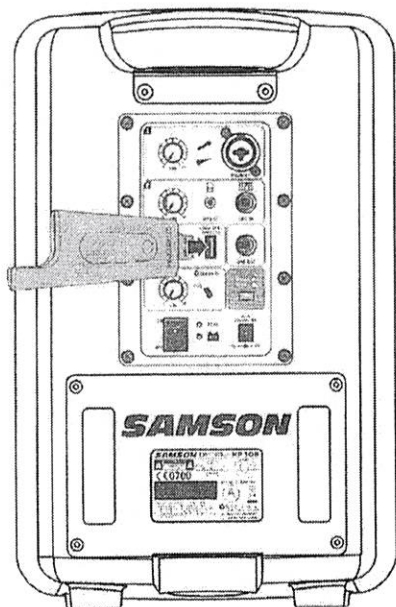

Plug the RXD1 USB receiver into the USB jack labeled 2.4GHz WIRELESS.

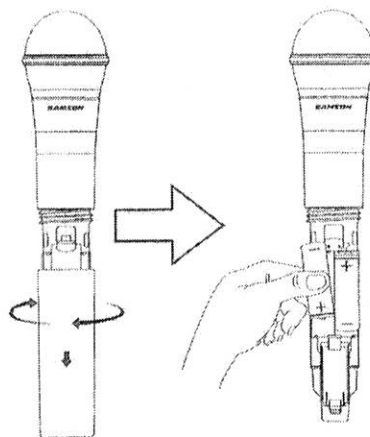

On the wireless handheld transmitter, unscrew the bottom section of the microphone by turning it counterclockwise and then slide it off. Place a fresh set of AA (LR6) batteries in the transmitter battery holder, taking care to observe the polarity markings, then replace the cover.

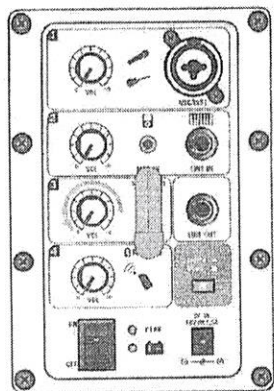

Turn the WIRELESS LEVEL knob on the XP106 completely counterclockwise to 0, then turn the POWER switch on the XP106 to the ON position.

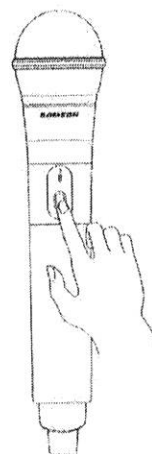

Turn on the power to the transmitter by pressing and holding Power switch; the indicator LED will light amber.

Making Connections

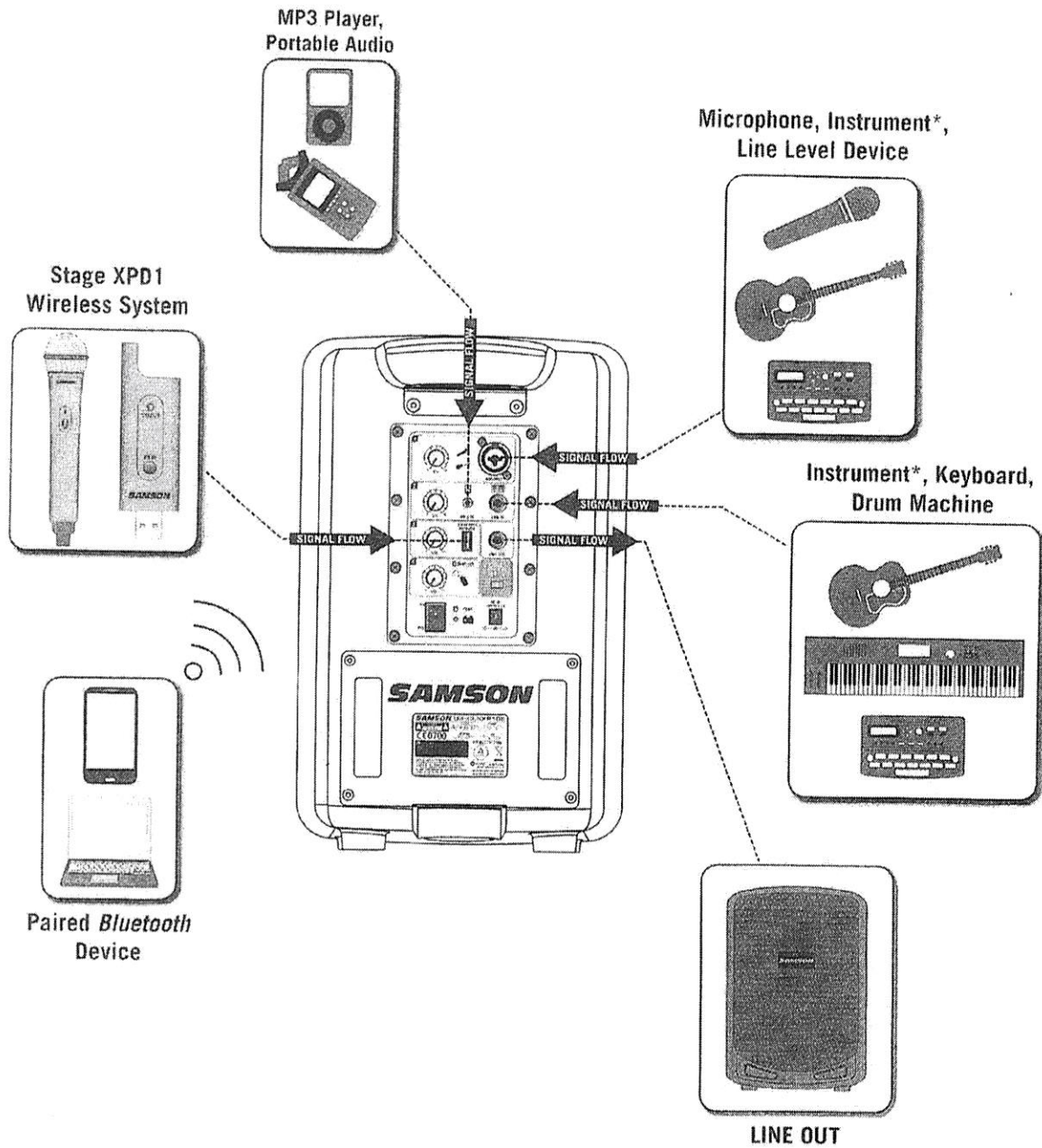

* An active preamp is needed in order to use acoustic instruments with the XP106.

ENGLISH
FRANCAIS
DEUTSCHE
ESPAÑOL
ITALIANO